

A
Bray
High
Performance
Company

Flow-Tek

A Subsidiary of BRAY INTERNATIONAL, Inc.

INSTALLATION - MAINTENANCE MANUAL (MCU1, MCU2, MCU3, MCU4)

MEDIA CONTAINMENT UNITS

APPLICATION

Flow-Tek media containment unit is designed to mount directly to Flow-Tek's flange (F15/ F30 /RF15) and 3PC 7000/8000 series valves.

INSTALLATION

Note: addition of an MCU may increase the valve operating torque by 30%.

To install, remove valve handle or actuator, insure that the thin packing nut (stem nut) is retained by the locking washer (a washer with tab bent to contact one flat of the thin nut), place the supplied gasket (PTFE) into the machined groove on the top face of the valve mounting pad, place the MCU assembly over the valve stem, insure the valve stem engages the MCU stem slot and secure with the supplied lock washers and cap screws. Tighten evenly using a criss cross pattern. Reinstall the handle or actuator as it was removed.

OPERATION

With V ring packings and 2 sets of bellvilles, need for adjustment is rare. The packing may be adjusted by flattening the stainless lock washer tab and tightening gently. Tighten carefully, avoid over squeezing the packing. Simply flatten the bellvilles, then back off 1/2 turn and re-secure the lock washer tab. Leakage of the primary valve stem seal can be reviewed through the monitoring port, a 1/4" NPT port on the MCU housing. A second port can be opened to allow purge or lubricate.

MAINTENANCE

Flow-Tek's MCU repair kits contain all seals required to rebuild the units. The MCU must be removed from the valve for rebuilding. Follow stem packing adjustment instructions above when installing the new seals, bearings and packings.

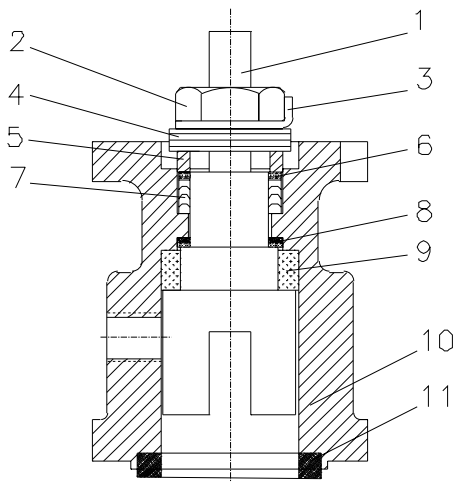

BILL OF MATERIALS:

| ITEM | PART NAME | MATERIAL | QTY. |
|------|-------------------|---------------|------|
| 1 | STEM | SS316 | 1 |
| 2 | PACKING NUT | SS304 | 1 |
| 3 | LOCK WASHER | SS304 | 1 |
| 4 | BELLEVILLE WASHER | SS301 | 2 |
| 5 | PACKING SLEEVE | SS304 | 1 |
| 6 | PACKING WASHER | 50/50 | 1 |
| 7 | STEM PACKING | PTFE | 3 |
| 8 | THRUST WASHER | 50/50 OR PTFE | 2 |
| 9 | STEM SUPPORT | 50/50 | 1 |
| 10 | BODY | A351 Gr CF8M | 1 |
| 11 | GASKET | PTFE | 1 |